  
**ELECTROLIFT**  
 Customer Service  
 1-800-338-9951

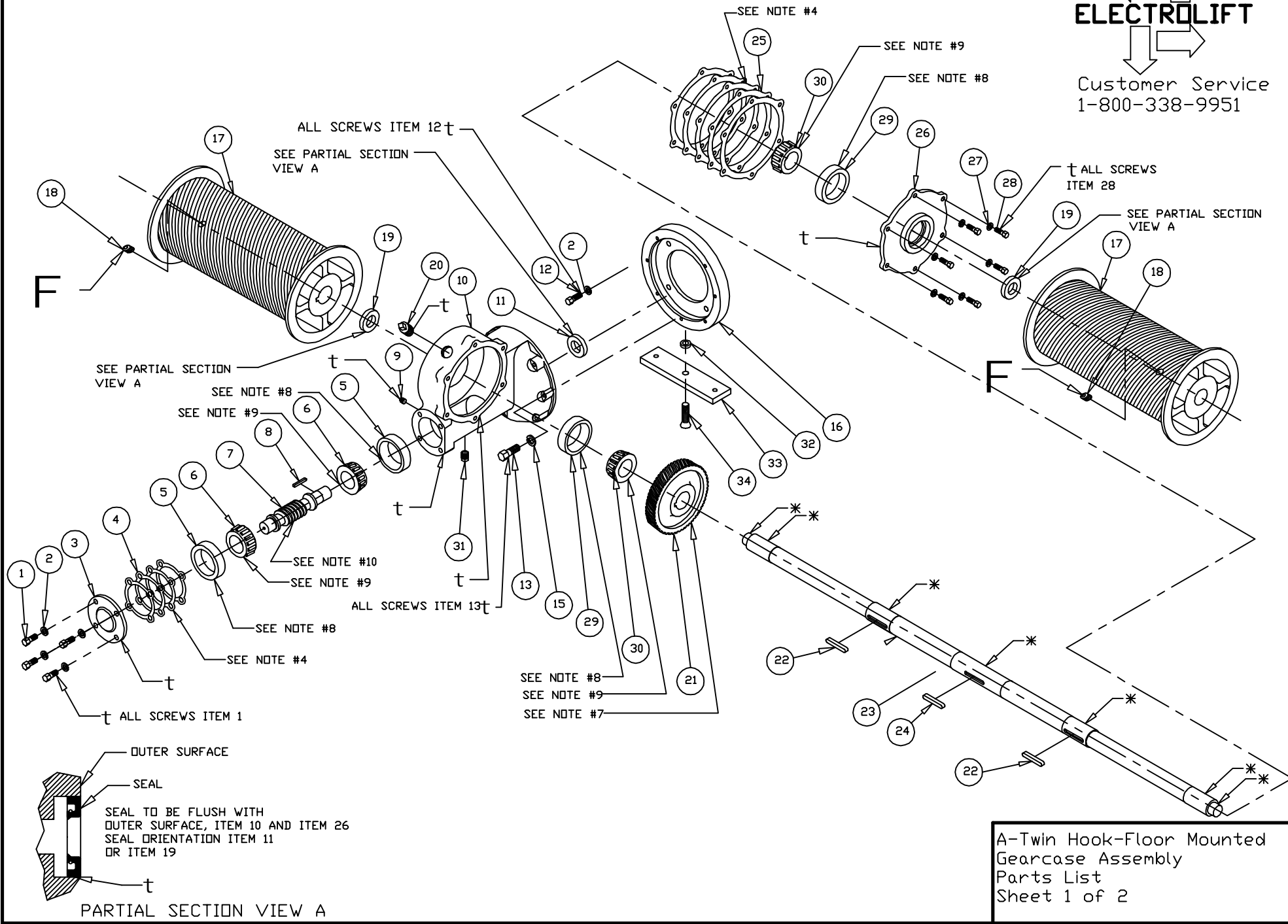

A-Twin Hook-Floor Mounted  
 Gearcase Assembly  
 Parts List  
 Sheet 1 of 2

34	FS568	1	SCREW, FHSCS, 1/2-13x1-3/4	ÖSEE NOTE A
33	K3102	1	STRAP, ADAPTER, MOTOR, A-TH-OVR:FLR MTD	
32	K11123	1	SPACER, 9/16 ID, 1 OD, 1/2 LG	
31	FS333	1	PIPEPLUG, 1/2 SQHD CORED	ÖSEE NOTE A
30	DM7003	2	BEARING, TRB, CONE, 1.50 ID	ÖSEE NOTE B
29	DM7004	2	BEARING, TRB, CUP, 3.00 OD	ÖSEE NOTE B
28	FS122	6	SCREW, HHCS, 5/16-18x7/8	ÖSEE NOTE A
27	FS312	6	WASHER, L, 5/16, PLAIN	ÖSEE NOTE A
26	M304A	1	COVER, SIDE, GEAR CASE, A	
25	K10753	1	KIT, SHIM, A-HOIST, SIDE COVER	
24	K10849P4	1	KEY, 5/16x5/16, 1-1/4, "A" WORM WHEEL	
23	----	1	SHAFT, JOB SPECIFIC	
22	K10849P5	2	KEY, 5/16x5/16, 2, A:B DRUM SHAFT	
21	----	1	WORM WHEEL, SEE NOTE #5	
20	FS337	1	PIPEPLUG, 1/2 SQHD CORED, W/STRAIGHT VENT	ÖSEE NOTE A
19	DM7028	2	SEAL, SHAFT, 1.5 ID, 2.37 OD	ÖSEE NOTE C
18	FS445	2	SOCKET HEAD SET SCREW 3/8-16x1/2, KNURLED	
17	----	2	DRUM, JOB SPECIFIC	
16	M2960A	1	ADAPTER, MOTOR, A-TH-OVR:FLR MTD	
15	FS310	7	WASHER, L, 1/4, PLAIN	ÖSEE NOTE A
14	N/A	-	----	
13	FS571	7	SCREW, HHCS, 1/4-20x1-1/2, GR2, PLAIN	ÖSEE NOTE A
12	FS129	4	SCREW, HHCS, 3/8-16x1, GR2, PLAIN	ÖSEE NOTE A
11	DM7216	1	SEAL, SHAFT, 1 ID, 1.82 OD	ÖSEE NOTE C
10	T478A	1	GEAR CASE, A TWIN HOOK HOIST	
9	FS336	1	PIPEPLUG, 1/8 SQHD, CAST IRON, SOLID	ÖSEE NOTE A
8	K10845P2	1	KEY, 3/16x3/16, 1-1/16, A MOTOR	
7	----	1	WORM SHAFT, SEE NOTE #5	
6	DM7000	2	BEARING, TRB, CONE, 1 ID	ÖSEE NOTE B
5	DM7001	2	BEARING, TRB, CUP, 2.56 OD	ÖSEE NOTE B
4	K10754	1	KIT, SHIM, A-HOIST, END COVER	
3	K101	1	COVER, END, GEAR CASE, A	
2	FS315	8	WASHER, L, 3/8	ÖSEE NOTE A
1	FS466	4	SCREW, HHCS, 3/8-16x7/8	ÖSEE NOTE A
ITEM #	PART #	QTY	DESCRIPTION	

BILL OF MATERIALS

NOTES:

- 1) \* - APPLY ANTISEIZE COMPOUND
- 2) t - APPLY PERMATEX ULTRACOPPER SEALANT ELECTROLIFT P/N DM7394
- 3) F - APPLY BLUE TYPE THREADLOCK COMPOUND, TORQUE TO 24 FT-LBS

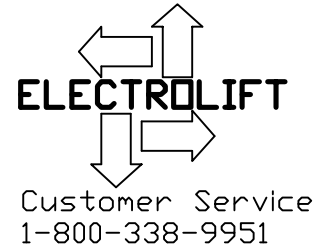

- 4) USE THE SAME AMOUNT AND COLOR OF SHIMS AS ORIGINAL SET.
- 5) IDENTIFICATION CHART

NO OF TEETH	WORM WHEEL P/N	WORM SHAFT P/N
44	M302	M301P1
55	M2856A	M2855
64	K903A	K940

- 6) OIL CAPACITY 14 OZ., EXXON CYLESSTIC TK680 OR EQUIV. E/L P/N DM7146 OR MOBIL SHC 634 OR EQUIV. (SYNTHETIC) E/L P/N DM7381
- 7) PRESS ITEM 21 ONTO ITEM 23 CENTRALLY LOCATED ON ITEM 24
- 8) PRESS ITEM INTO MATING HOUSING OR COVER
- 9) TO BE PRESSED ON MATING SHAFT
- 10) TAP WITH Mallet AFTER PRESSING ITEM 5

Ö KIT NOTES:

- A) THIS PART CAN ONLY BE ORDERED AS PART OF GEARCASE HARDWARE KIT #K11256
- B) THIS PART CAN ONLY BE ORDERED AS PART OF GEARCASE BEARING KIT #K11151.
- C) THIS PART CAN ONLY BE ORDERED AS PART OF SEAL KIT #K11153.
- D) FOR BOTH SEALS & SHIMS, ORDER SEAL & SHIM KIT #K11279.

A-Twin Hook-Floor Mounted Gearcase Assembly Parts List Sheet 2 of 2